



DESCRIPTION

The mounting consists of a rubber element bonded between steel plates. The rubber is protected by flexible paint.

APPLICATION

The Type 'PD' mount is a general-purpose resilient mount used primarily for vibration isolation. For shock isolation installations the snubber washers are used in pairs to provide captivity.

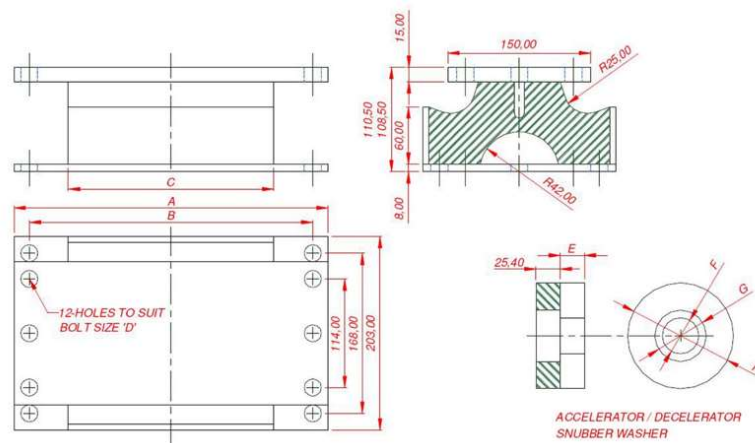

Part No.	NATO Stock Number	Mount Size	Component	Supported Mass kg	Dimensions							
					A	B	C	D	E	F	G	H
15/201	5340-99-537-5052	P5D	Mount	750-1100	210	178	127	M12				
15/202	5340-99-537-5053	P5D	Washer						16	26	48	86
15/203	5340-99-537-5054	P7D	Mount	1160-1700	267	235	184	M12				
15/204	5340-99-537-5055	P7D	Washer						19	32	51	98
15/205	5340-99-769-7909	P8 ¼ D	Mount	1700-2500	330	298	216	M16				
15/206	5340-99-537-5057	P8 ¼ D	Washer						25.4	38	54	11